

CICP2100 uniVerse™

POE CONTROLLER

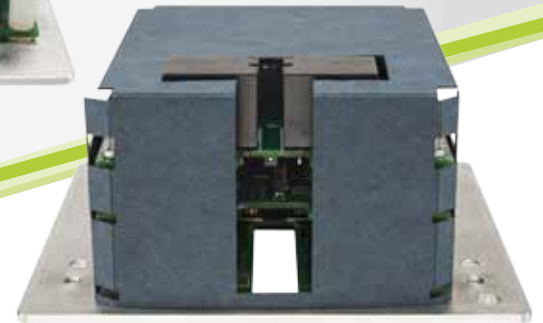

CICP2100

The Continental CICP2100 uniVerse™ Single Door Controller provides support for two (2) readers on one door, using power over ethernet (POE).

Used in a CA3000 or CA4K access control software environment, the tamper-supervised CICP2100 Power Over Ethernet Controller, supports two readers and/or one low current strike via POE, fits in any standard double gang electrical box, and can be used networked with, or in place of more traditional expandable Accelaterm or Supertwo Controllers and/or Networkx Wireless Access Control Locks. Includes metal faceplate cover with LED indicator status window and connection-diagrammed secure self-sleeve. *(Double Gang box, not supplied).*

- POE Panel Supports 2 Readers for 1 Door
- Supports 2 Wiegand Readers or one Wiegand and one RS-485 (2-wire) reader
- Superfast ARM Processor
- Supports 200K cards
- 4MB on-board memory
- 1000 Standard transaction buffer, Expandable to 10,000
- 256 Time schedules; 30,000 Access groups; 5x100 Holidays
- 2 Form C Relay outputs, door and auxiliary (MOV-protected)
- Reader & Accessory Power- 320ma @5VDC & 700ma @12VDC
- POE Onboard Ethernet
- High speed 921.6 KBPS baud communication support
- Supports RS-485 Repeat Communications (4-wire)
- 4 Supervised inputs
- Supervised Tamper
- Unsurpassed FIPS/CAC/TWIC performance
- ETL LISTED. Conforms to UL STD 294 and Certified to ULC STD S319 as noted on the ETL Listing Mark Label on the product.

CICP2100 Specifications

POWER

- POE Onboard Ethernet
- Input Voltage: 12 VDC

ENVIRONMENTAL

- Operating Temperature: 32 - 120°F (0 - 49°C)
- Storage Temperature: -32 - 149°F (0 - 65°C)

PHYSICAL CHARACTERISTICS

- Fits within a standard double gang box, approximately 2 3/4" W, 3 1/2" H, 2" D, plus cover plate, 0.5lbs.
- Durable Metal Cover Plate, supplied, mounts to cover standard double gang electrical box

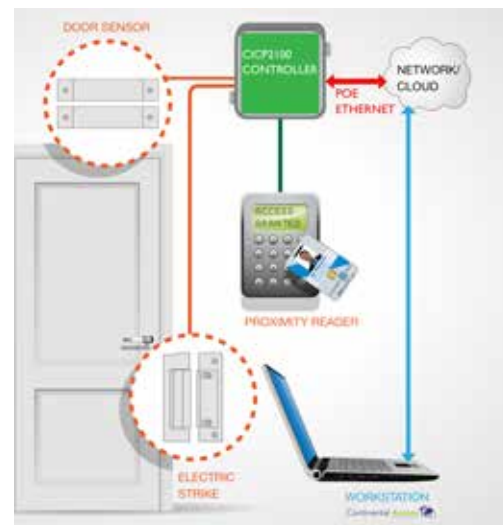

Continental Access 
A Napco Security Group Company
www.cicaccess.com

CONTINENTAL ACCESS, 355 BAYVIEW AVE., AMITYVILLE, NY 11701 1.800.645.9445 ++ (631) 842-9400 FAX 631.842.9135

UNIVERSE, CA4K AND CA3000 ARE TRADEMARKS OF CONTINENTAL DIVISION OF NAPCO A695B SPECIFICATIONS SUBJECT TO CHANGE WITHOUT PRIOR NOTICE © 10.2016 NAPCO